



E-Connection

1558-22

**Calamity Plan
Offshore Windpark
Rijnveld Noord/Oost**

Calamity Plan
OFFSHORE WINDPARK
RIJNVELD NOORD/OOST

Calamity Plan
Offshore Windpark
Rijnveld Noord/Oost

Opgemaakt door:

E-Connection Project BV
Postbus 101
3980 CC Bunnik

Tel. (030) 6598000
Fax (030) 6598001

e-connection@e-connection.nl
www.e-connection.nl
Juni 2007

**CALAMITY PLAN
OFFSHORE WINDPARK
RIJNVELD NOORD/OOST**

June 2007

Emergency Procedures during the Operational Period

BUNNIK, 2007

E-CONNECTION PROJECT BV

POSTBUS 101

3980 CC BUNNIK

Revision record

Author	Approved	Date	Revision	Note	Sign
J.H. den Boon		11-06-2004	B2	Comments NL Coast Guard	
P. Stumpf B. Thiele	J.H.DEN BOON	17-09-2004	B3	Comments RWS-DNZ and NL Coast Guard	
J.H. den Boon	M.A.J.KORTENOEVER	29-10-2004	B4	Comments RWS-DNZ 26-10-2004	
M.vander Hulst	M.A.J.KORTENOEVER	08-06-2006	B5	Updated and revised for P12	
M.vander Hulst		24-05-2007	B6	Updated and revised for Rijnveld Noord/Oost	

Table of Contents

1	Scope of Document.....	3
2	Project Information.....	4
3	Reference Documents.....	8
4	Overview of Wind Park Operations.....	8
5	Consideration of Wind park Operations.....	9
6	Summary of Emergency Scenarios and Response Procedure.....	10
7	Communications With NLCG-DH in the Event of an Extra Incident.....	11
8	Emergency Service Contacts.....	11
9	Summary, Conclusion & next Actions.....	11
10	Appendices.....	12
	Appendix A – Offshore Access System.....	13
	Appendix B – Safety Equipment for Working at Heights.....	14
	Appendix C – Fire, No Personnel on the WTG / OHVS Procedure.....	16
	Appendix D – Fire, Personnel on the WTG / OHVS Procedure.....	17
	Appendix E – Walking Casualty Procedure.....	18
	Appendix F – Single Stretcher Casualty Procedure.....	19
	Appendix G – Stranded By Weather Procedure.....	20
	Appendix H – Man Over Board (MOB) Procedure.....	21
	Appendix I – Incapacitated service Vessel Procedure.....	22
	Appendix J – Diving Incident Procedure.....	23
	Appendix K – Stop of WTG Procedure.....	24
	Appendix L1 – Oil spill respons procedure 1.....	25
	Appendix L2 – Oil spill respons procedure 2.....	26
	Appendix M – Collision Procedure.....	29
	Appendix N – Survival Kit Supplies.....	30
	Appendix O – Emergency Service Contacts.....	31

GLOSSARY OF TERMS USED:

EMPLOYER	Owner of the Wind Park
LAT	Lowest Astronomical Tide
MOB	Man Over Board
NLCG DH	Netherlands Coastguard – Den Helder
NOK	Next of Kin
Rijnveld Noord/Oost	Offshore Windpark Rijnveld Noord/Oost
OHVS	Offshore High Voltage Station
OMC	Offshore Maintenance Coordinator
O & M	Operation and Maintenance
RCC DH	Rescue Coordination Centre – Den Helder
STI	Safety Training Institute
VCEU	Vestas
WTG	Wind Turbine Generator
ERC	Emergency Response Coordinator

1 SCOPE OF DOCUMENT.

This document is to consolidate emergency response arrangements for the operational period of Offshore Windpark Rijnveld Noord/Oost (hereafter WP Rijnveld Noord/Oost).

This document is owned by the Windpark operator, and held live for update and revision as work progresses and protocols mature.

During the operational phase this document is held live and updated by the Operational Manager of WP Rijnveld Noord/Oost.

2 PROJECT INFORMATION.

Offshore Windpark Rijnveld Noord/Oost is located outside the 12-mile zone in the southern part of the Dutch North Sea, approx. 35 km west of Katwijk.

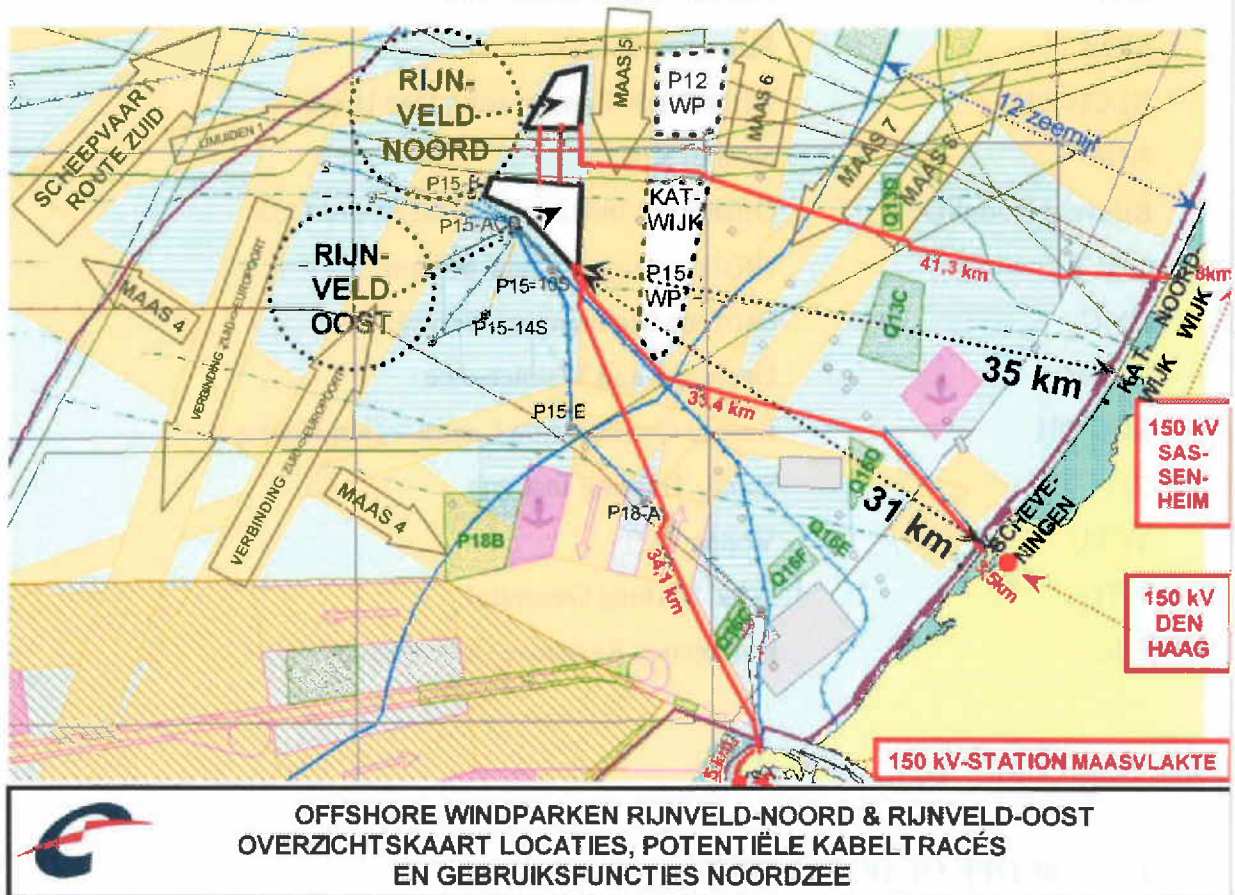



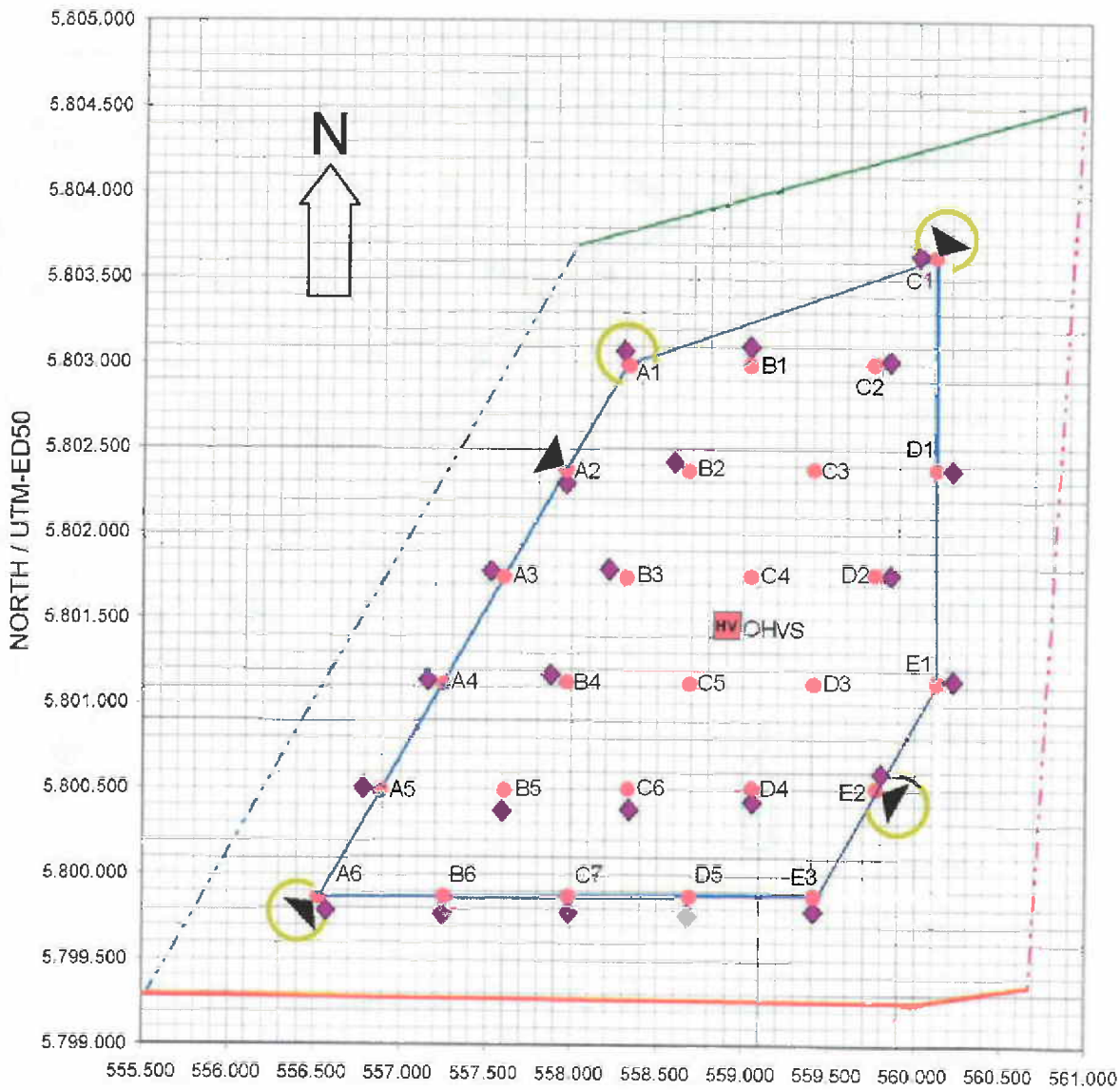

Offshore Windpark Rijnveld Noord/Oost comprises 72 offshore Wind Turbines Generators and Offshore High Voltage Station.

All offshore Wind Turbines Generators are identical, type V90, made by Vestas and have variable speed.

The Wind Turbines Generators are of the upwind type, and have three rotor blades with a diameter of 90 m. The hub height of the rotor-axis from the wind turbines is approx. 64 m above LAT.





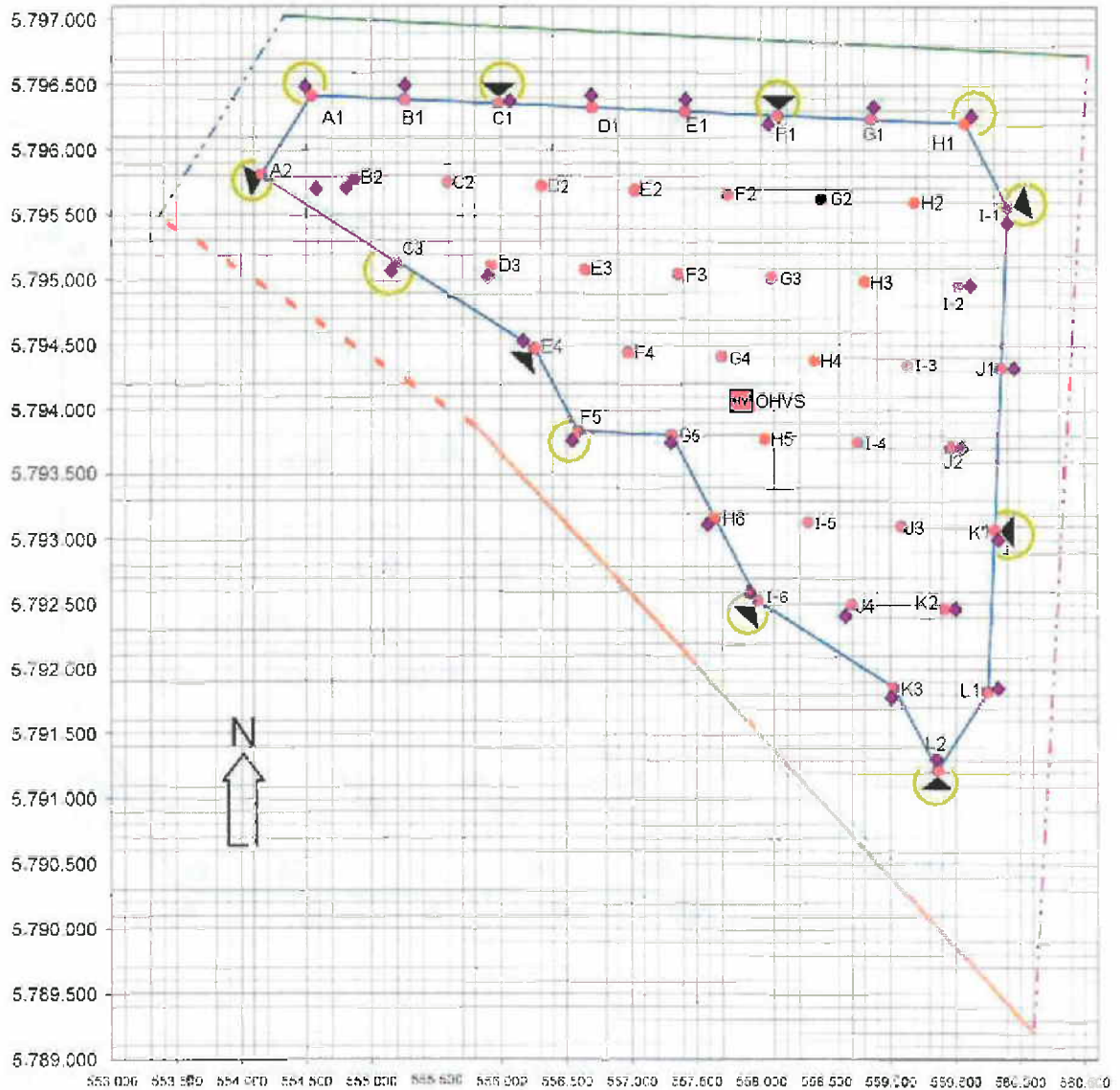

**OFFSHORE WINDPARK RIJNVELD-NOORD
NAUTICAL & AERONAUTICAL NAVIGATION AIDS**

-  = windturbine with yellow flashing marine lantern at 15 m above sealevel
-  = foghorn
-  = windturbine with red aeronautical obstruction light at the roof of the nacelle of the windturbine
-  = offshore High Voltage station with red aeronautical obstruction light
-  = windturbine with IALA-radar reflector at 15 m above sea-level combines with a yellow retroreflective wisk cone

© F-Conisecton, Bunnik



**OFFSHORE WINDPARK RIJVELD-OOST
NAUTICAL & AERONAUTICAL NAVIGATION AIDS**

-  = windturbine with yellow flashing marine lantern at 15 m above sealevel
-  = foghorn
-  = windturbine with red aeronautical obstruction light at the roof of the nacelle of the windturbine
-  = offshore High Voltage station with red aeronautical obstruction light
-  = windturbine with IALA-radar reflector at 15 m above sea-level combines with a yellow retroreflective wisk cone

© ECN/NOUW, 2006

